

INSTALLATION MANUAL



STEEL SHINGLES



ideal roofing
Company Limited, Manufacturers

Head Office
1418 Michael St.,
Ottawa, Ont., Canada K1B 3R2
TOLL FREE 1-800-267-0860
TEL. 1-613-746-3206
FAX 1-613-746-0445

Contents

| | Page |
|--------------------------------------------------------------|-------|
| Installation, Storage, Tools..... | 2 |
| Safety Tips, Maintenance, Touch Up Paint, Important Notice.. | 3 |
| Direction of Application..... | 4 |
| Installation Details Overview..... | 5 |
| Eave and Gable Details..... | 6 |
| Wall Flashing Details..... | 7 |
| Valley Detail..... | 8 |
| Cottage Roof Details..... | 9 |
| Transition Flashing Detail (high to low pitch)..... | 10 |
| Transition Flashing Details (low to high pitch)..... | 11 |
| Ridge Details..... | 12 |
| Half Ridge Cap Details..... | 13 |
| Plumbing Vent and Hydro Mast Details..... | 14 |
| Snow Guard Detail..... | 15 |
| Flashings & Trims..... | 16 |
| Appendix "A" – Roof Bracket..... | 17 |
| Estimate Sheet..... | 18-19 |



Installation

- The “**Wakefield Bridge**” steel shingles must be installed on roofs with a minimum pitch of 4/12.
- For the best results, **Ideal Roofing** recommends the removal of the asphalt shingles prior to installing the “**Wakefield Bridge**”. First inspect the deck underneath and replace any damaged decking then apply the underlayment. Consult your local distributor for the choice of the appropriate underlayment.
- For re-roofing over existing asphalt shingles, inspect the deck underneath to ensure a solid base. Correct or remove curled up shingles then apply a synthetic waterproof underlayment before installing the “**Wakefield Bridge**”. **This application requires 1 ½” long screws and starter #815.**
- For new construction and in climates that experience freezing temperatures and (or) high winds, use waterproof peel and stick membrane on the first 36” from the eave, 12” from the edge of the gable, 36” on each side of the valley, 12” around skylights and chimneys. For the remainder of the roof, use synthetic waterproof underlayment. On roofs with multiple slope variations and dormers, the use of peel and stick membrane on the entire roof surface is highly recommended. Consult your local distributor for the choice of the appropriate underlayment. **This application requires the starter #815.**

Storage

- Storage time should be minimized by installing the metal shingles as soon as possible. If shingles must be stored for an extended period, the ideal storage place is under a roof in a cool, dry and well ventilated area.
- When outdoor storage is unavoidable, the following is recommended:
 - 1- Use good quality covers over stacks,
 - 2- Block bundles off the ground,
 - 3- Store away from chemically aggressive substances (e.g. salt, cement, fertilizer, diesel, oil, paint, and grease).

Tools

- Electric screw gun with adjustable torque.
- Tin snips or nibblers.
- Measuring tape.
- Screw (nail) apron.
- Rubber mallet.
- Locking sheet metal pliers (“Vice Grip” type).
- Folding tool.



Safety Tips

- *Working gloves.*
- *Proper eye protection.*
- *Hard hat.*
- *Rubber-soled shoes (Steel roofing can be slippery when wet or icy).*
- *Properly secure material on the roof.*
- *Safety harness.*
- *Knee pads.*
- *Avoid installing on a windy day.*
- *Avoid having loose materials and tools on the roof.*
- *Avoid walking on the locks/seams of the shingles.*
- *Secure area below work.*
- *Use proper attachment for fall protection.*

Maintenance

- *When walking on the roof, avoid stepping on the interlocks of the steel shingles.*
- *To avoid scratching the paint on the “Wakefield Bridge” Steel Shingles, make sure to clean up the bottom of your rubber-soled shoes from any stones or debris before stepping on the roof*
- *Inspect and remove any debris (leaves, nails, ...) on an annual basis*

Touch Up Paint

- *In the event of minor scratches, the installer should use a fine detail brush to cover only the scratch using minimum amount of paint. For multiple scratches or major paint damage, replace immediately the affected panels.*

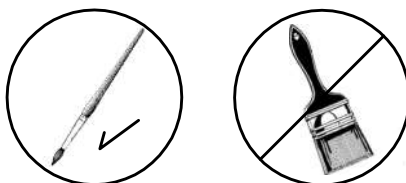

Note: *The shine of the touch up paint might have a slight difference from the original pre painted steel.*

Important Notice

- *When ordering pre-painted “Wakefield Bridge” Steel Shingles, it is always preferable to order all items of the same colour at the same time to avoid slight colour differences between batches.*
- *The material should be checked against the shipping list as soon as it is received. Any damage or shortage of material on the bill of lading should be noted and reported to the driver or to our offices immediately.*
- *Do not use pressure treated lumber in direct contact with the “Wakefield Bridge”.*
- *Ideal Roofing will deliver the “Wakefield Bridge” steel shingles to its dealers only. No job site delivery will be done by Ideal Roofing.*



Direction of Application

The "Wakefield Bridge" Steel Shingles must be installed from left to right. Ideal Roofing recommends (for aesthetic reasons only), to start with a full panel on the first row, 2/3 and 1/3 of panel to start the second and third row. Repeat the steps for the remainder of the roof section.

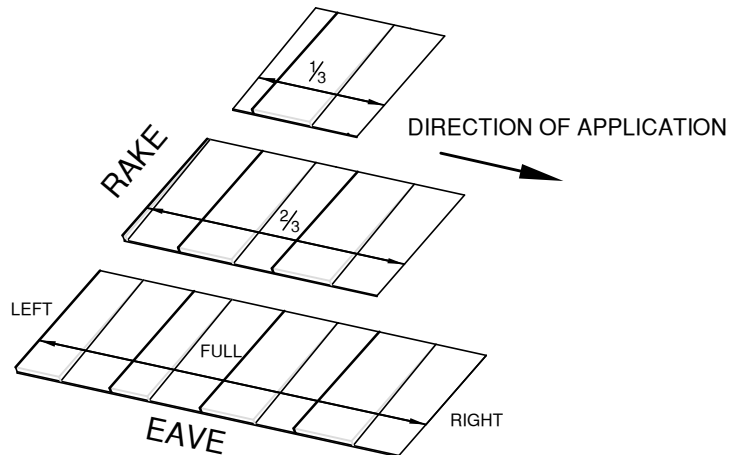
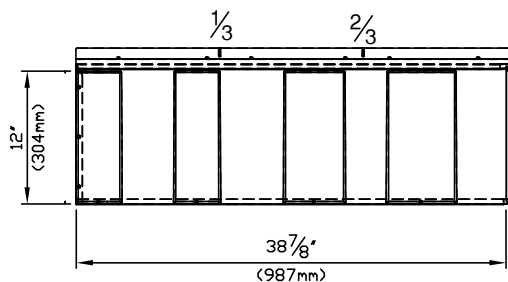

ROOF TYPES: PLAN VIEWS

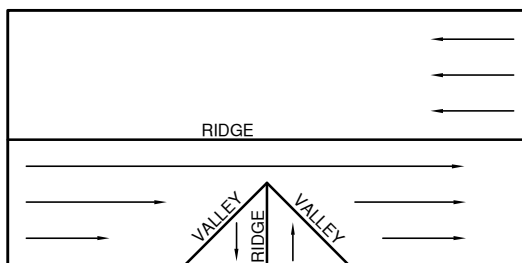
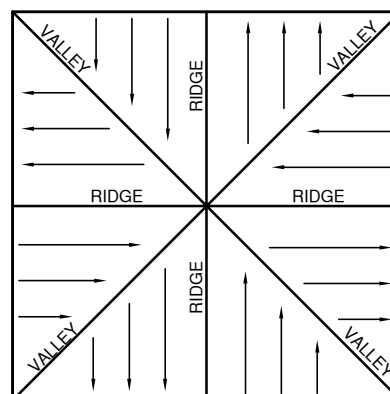
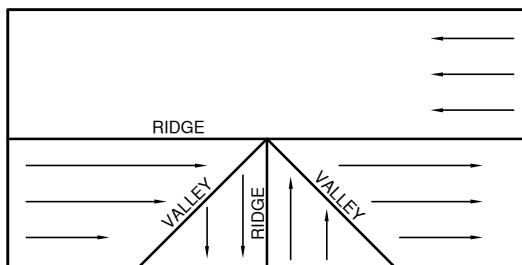
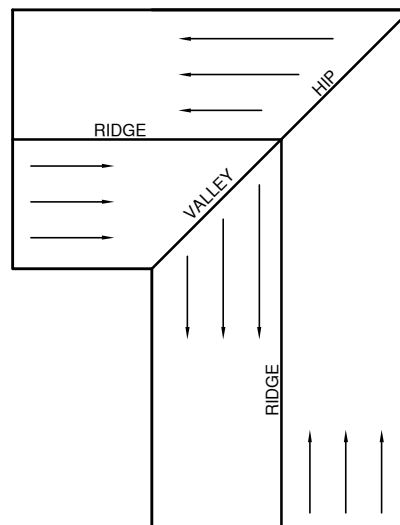
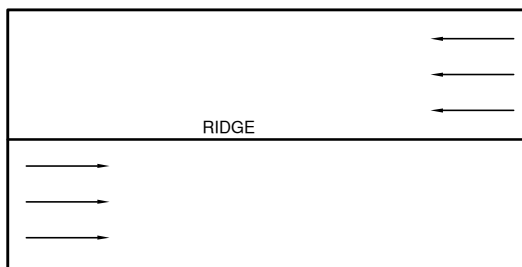

INSTALLATION DETAILS OVERVIEW

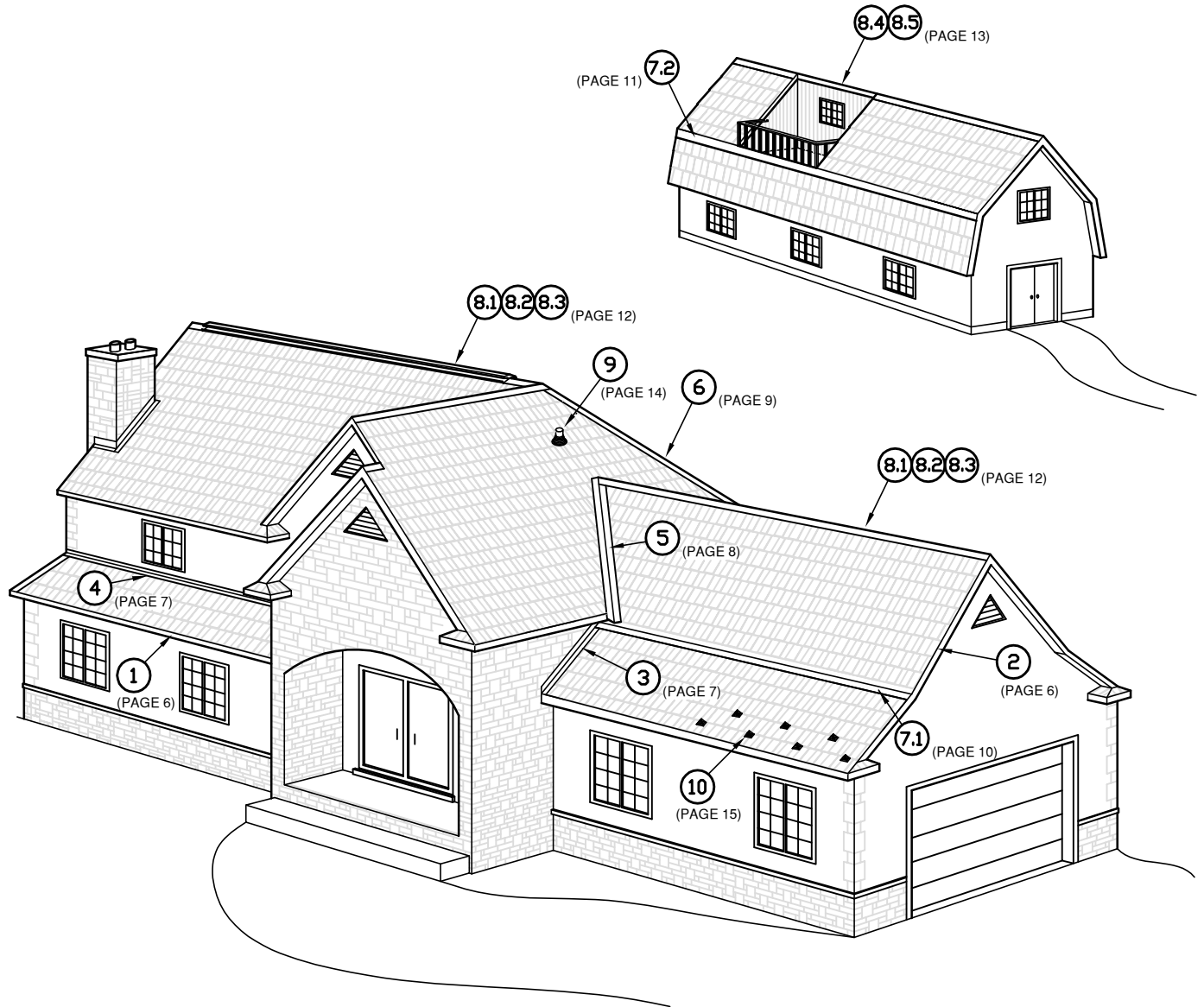

1 EAVE DETAIL

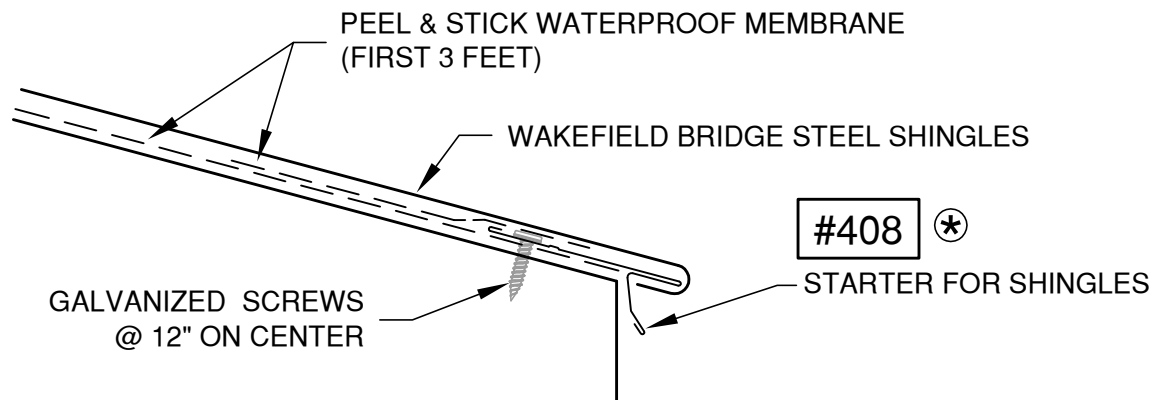

2 GABLE END DETAIL (first and last panel)

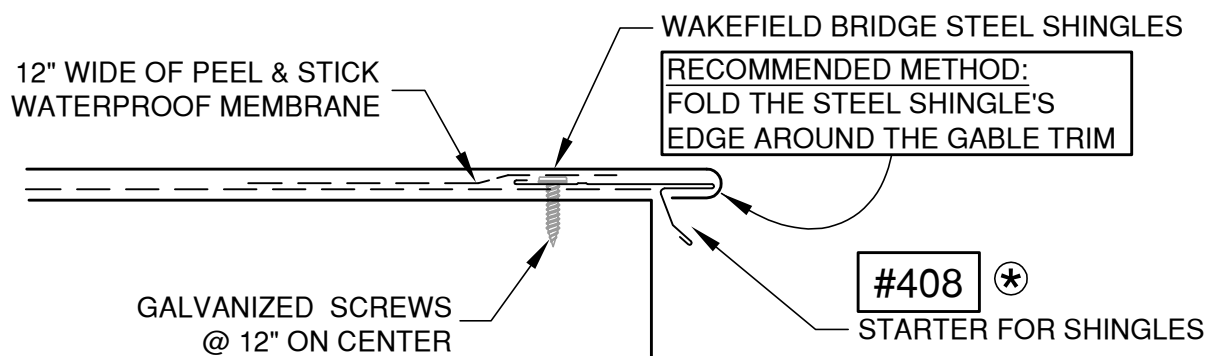

OPTION:

- THE #916 "J" TRIM IS AVAILABLE FOR THE ROOFER WHO WISHES TO INSTALL THE WAKEFIELD BRIDGE SHINGLES WITHOUT HAVING THE NEED TO FOLD THE STEEL SHINGLES ALONG THE GABLE'S STARTER TRIM.
- MAKE SURE TO COMPLETELY FILL THE #916 "J" TRIM WITH BUTYL CAULKING IN ORDER TO AVOID THE POSSIBILITY OF HAVING THE "J" TRIM OPENING UP DUE TO SNOW & ICE.
- DO NOT USE THE #916 "J" TRIM ON A GABLE END IF SNOW & ICE SLIDES DOWN A VALLEY DIRECTLY INTO THE GABLE END. THIS WILL MOST LIKELY RESULT IN THE "J" TRIM OPENING UP.
- DO NOT USE THE #916 "J" TRIM IN VALLEYS.

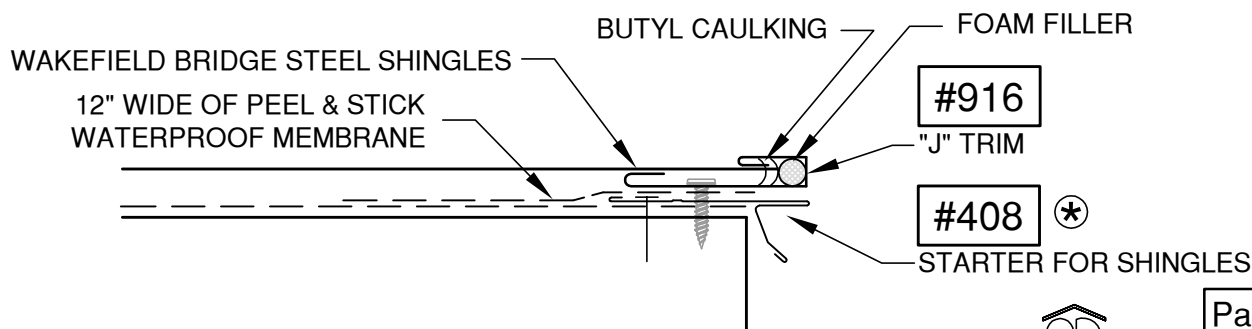

3 WALL FLASHING DETAIL (90°)

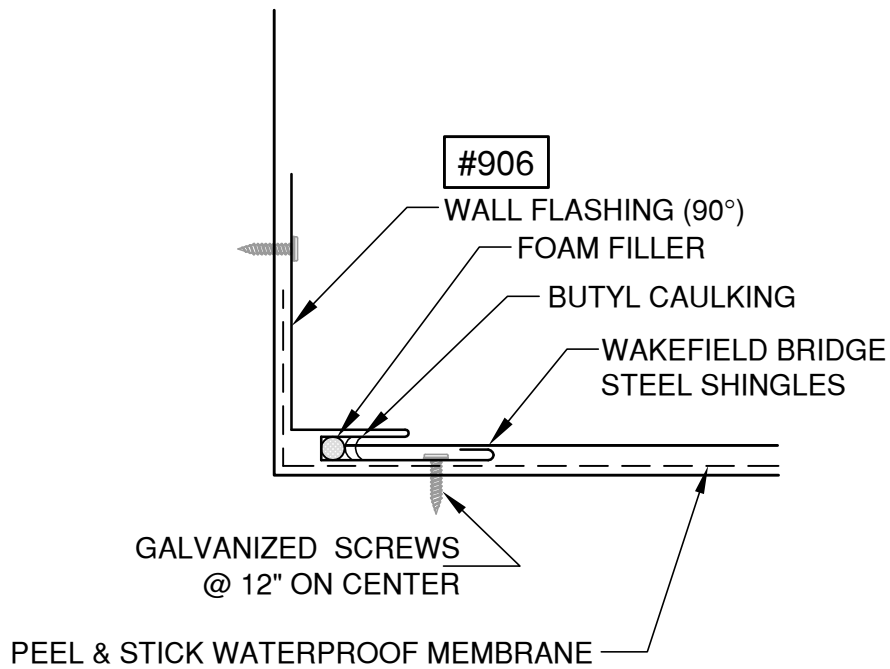

4 WALL FLASHING DETAIL (SLOPED)

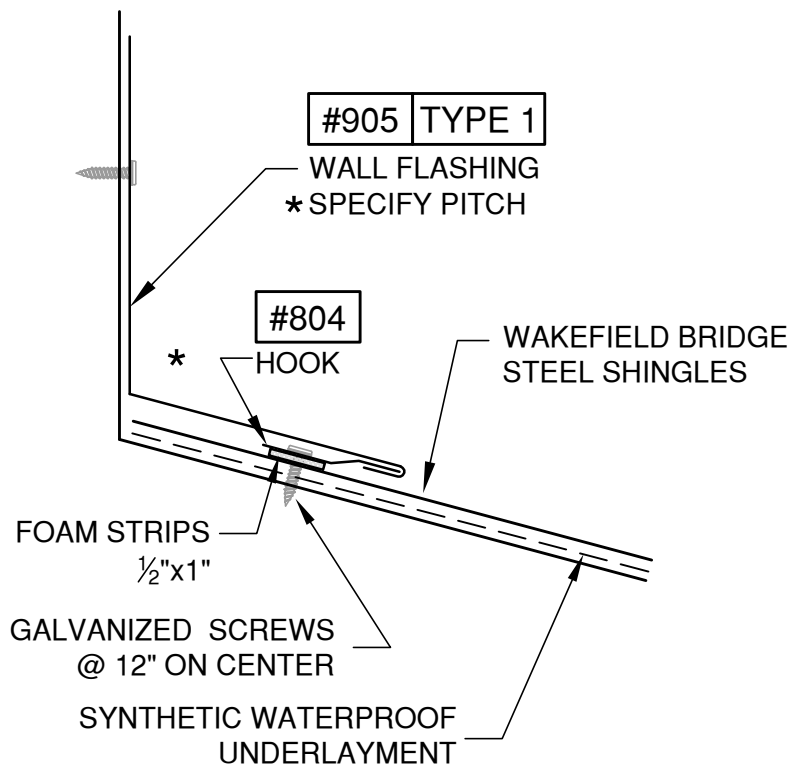

5

VALLEY DETAIL

(SHINGLES FOLDED ON SITE)

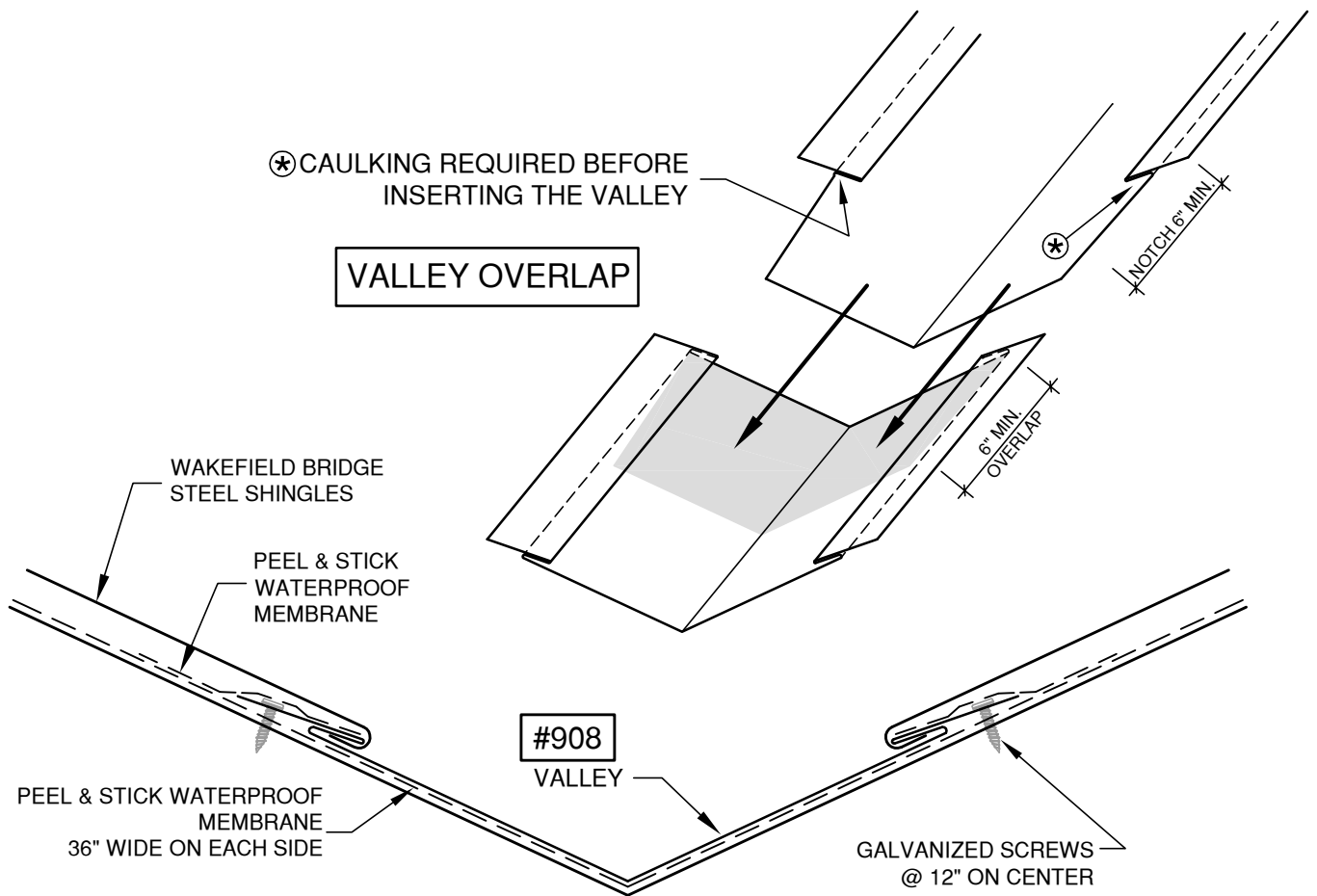

6.1

COTTAGE ROOF DETAIL

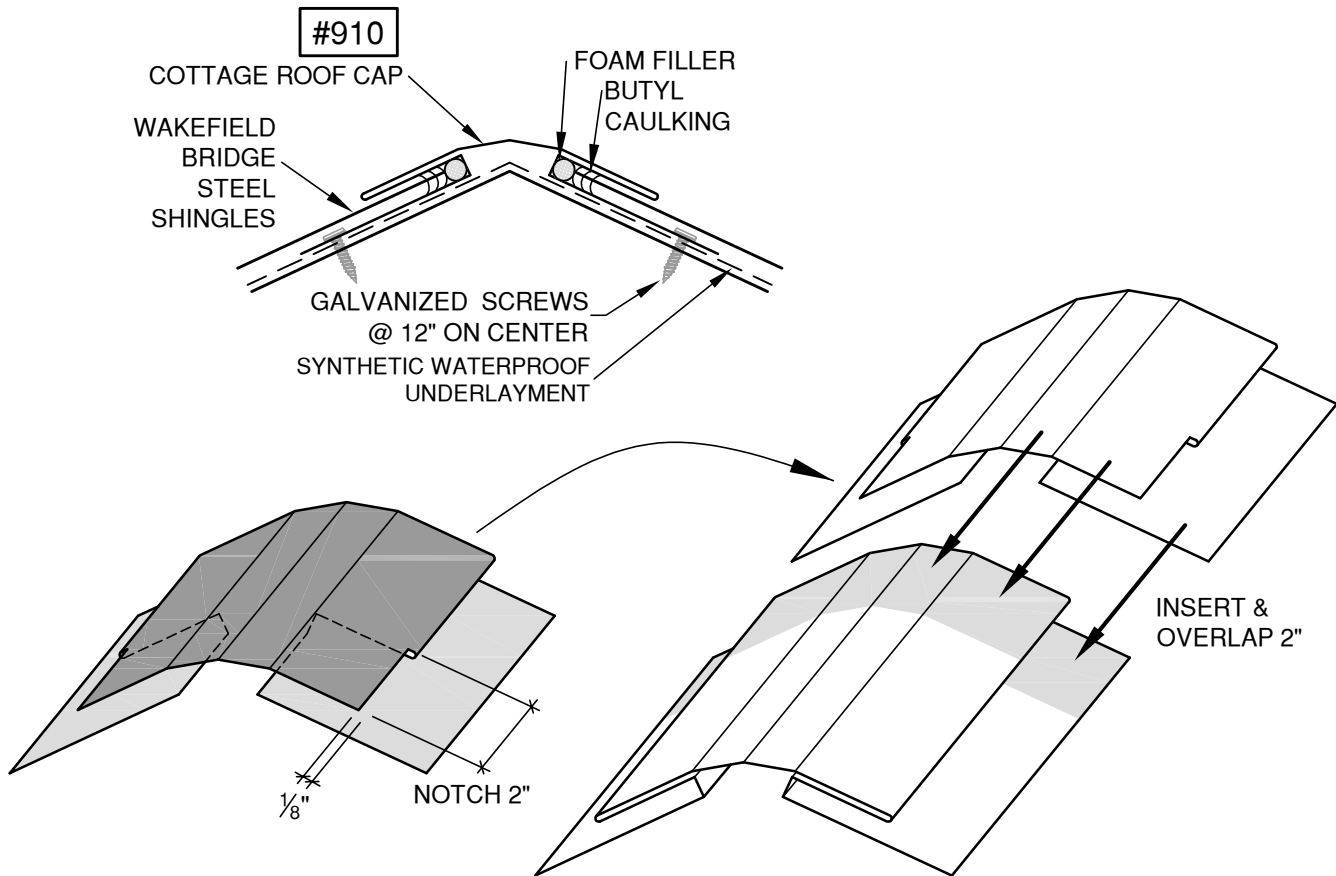

6.2

COTTAGE ROOF DETAIL

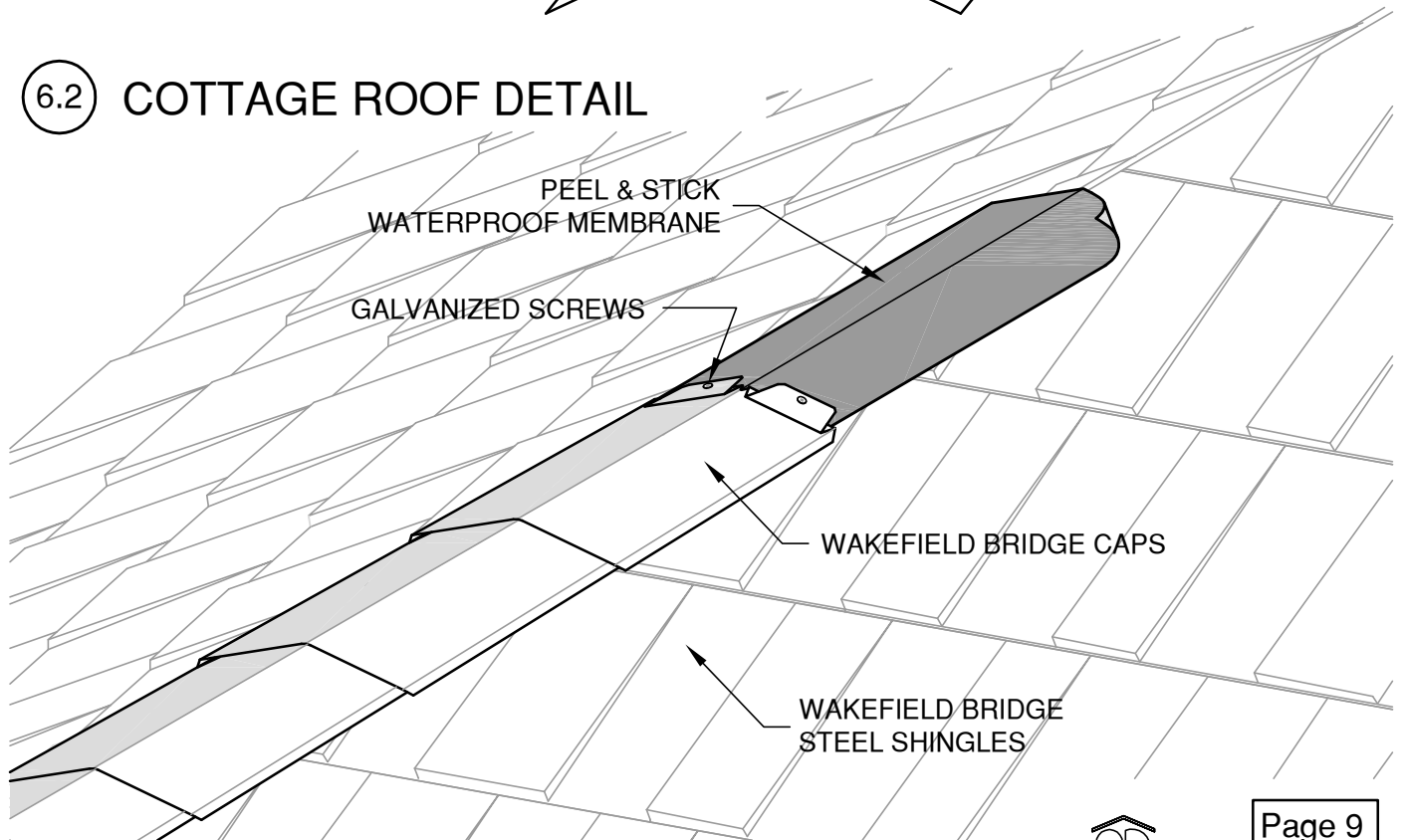

7.1 TRANSITION FLASHING DETAIL (high to low pitch)

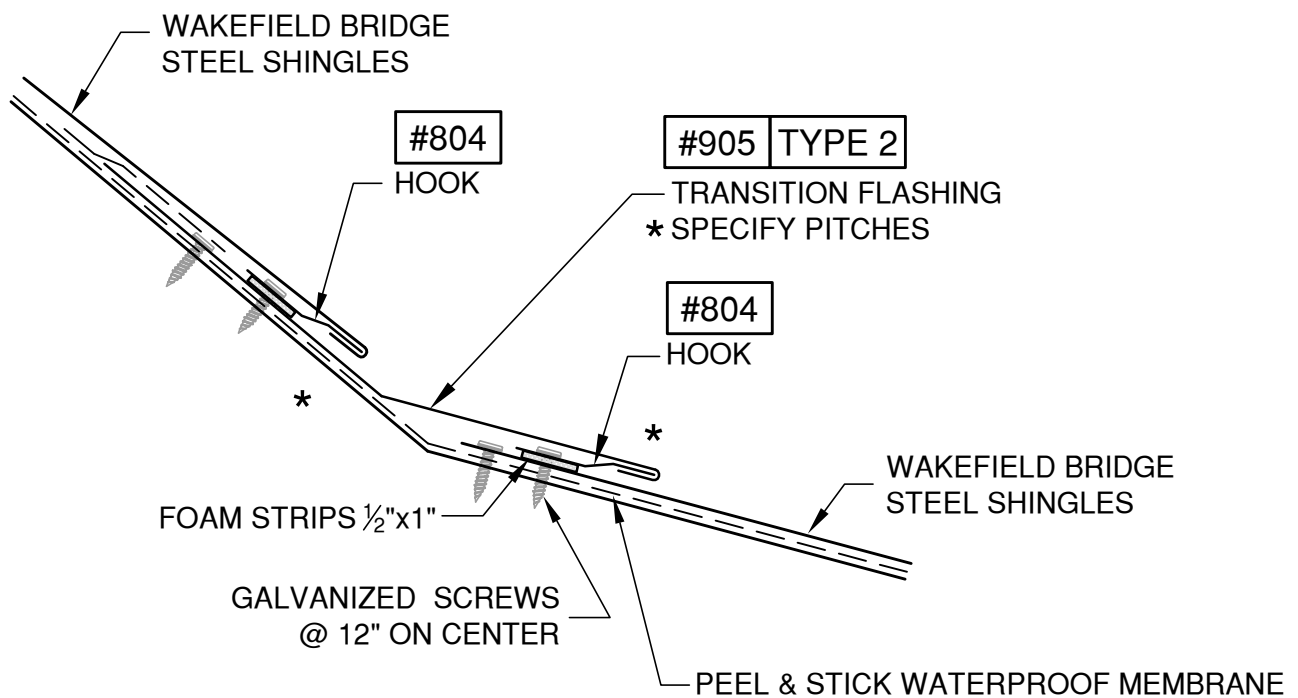

7.2a TRANSITION FLASHING DETAIL (low to high pitch)

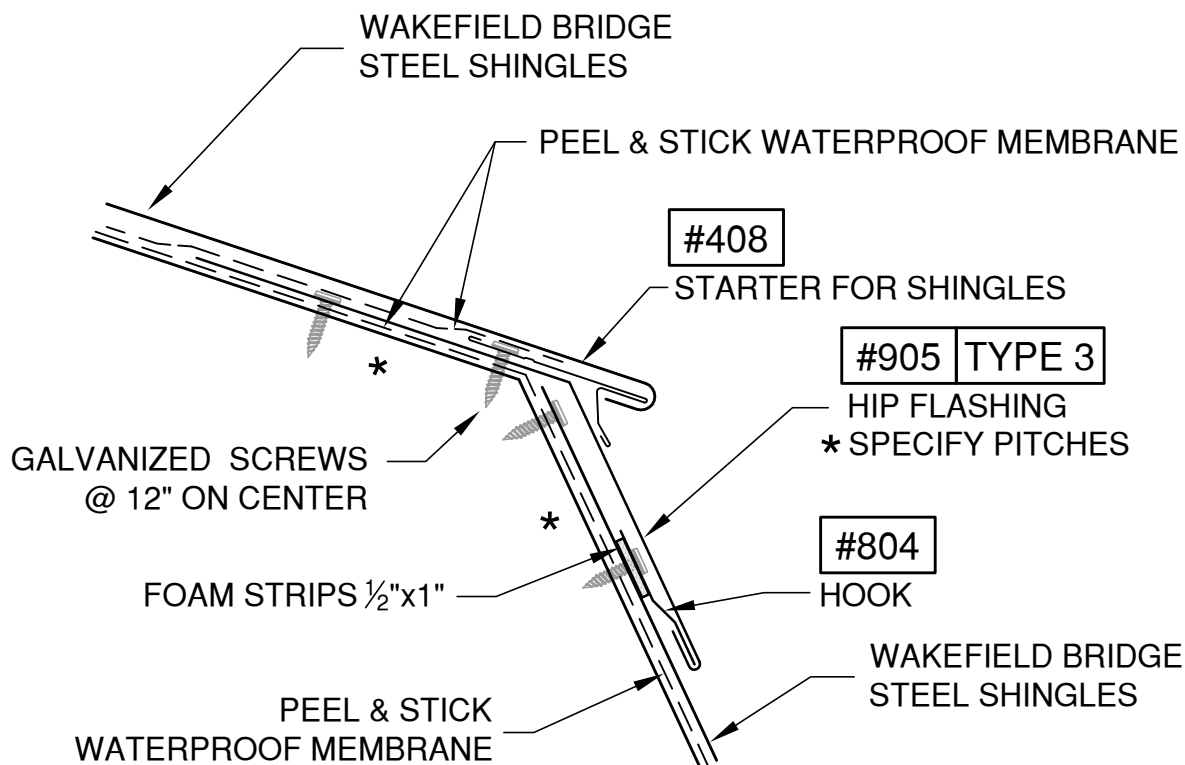

7.2b TRANSITION FLASHING DETAIL (low to high pitch)

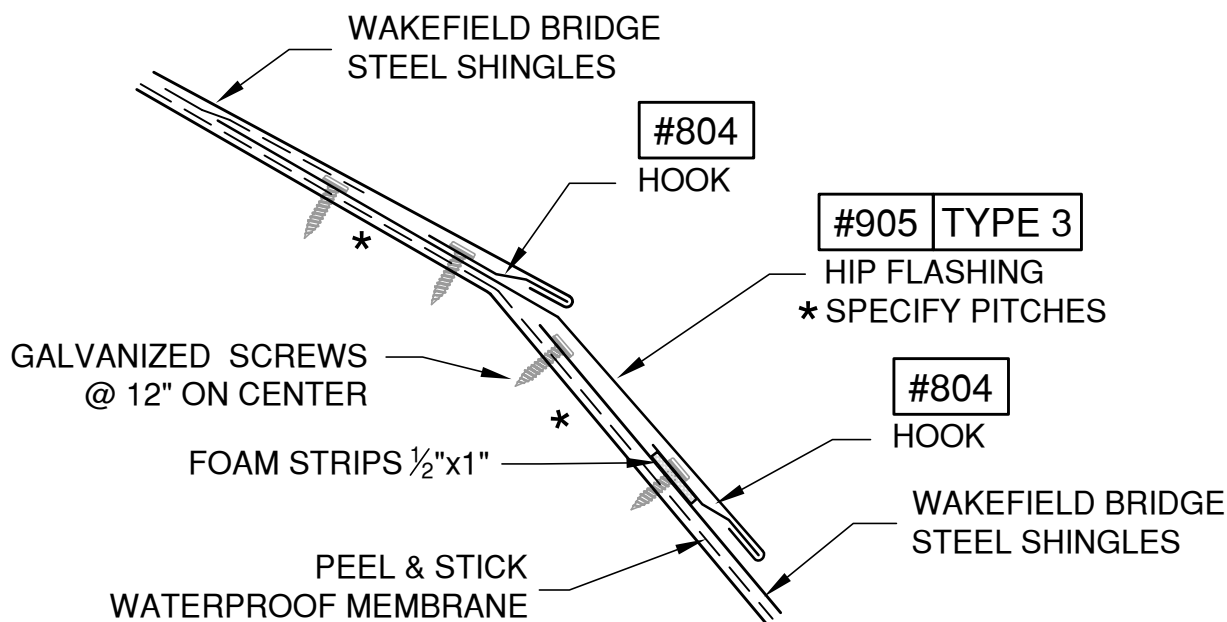

8.1

RIDGE DETAIL

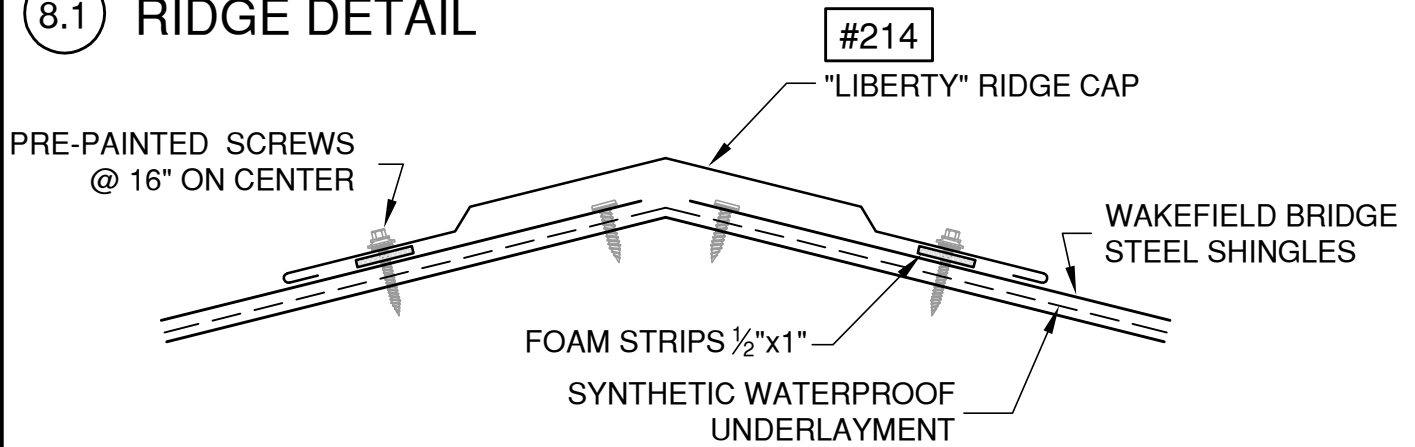

8.2

RIDGE DETAIL

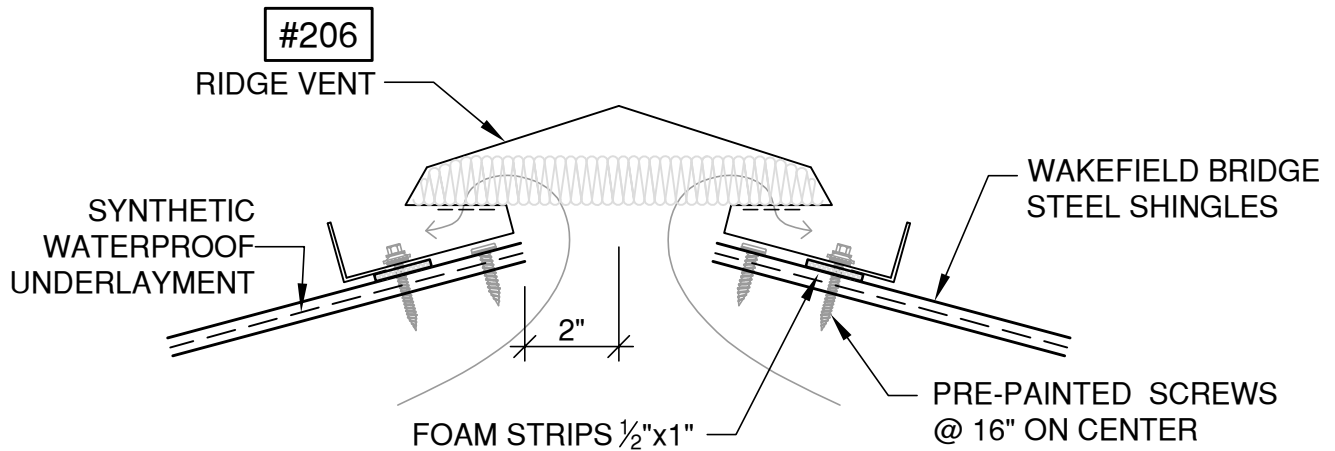

8.3

RIDGE DETAIL

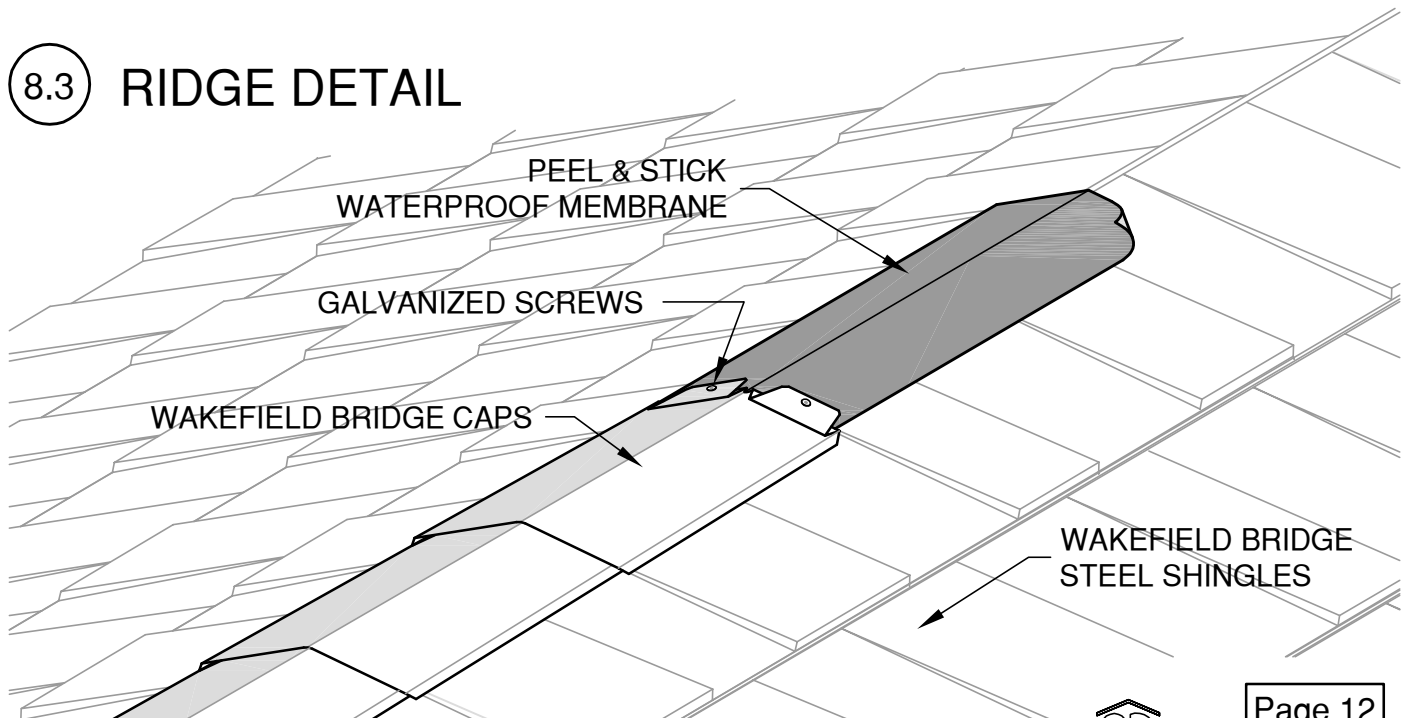

8.4 HALF RIDGE CAP DETAIL

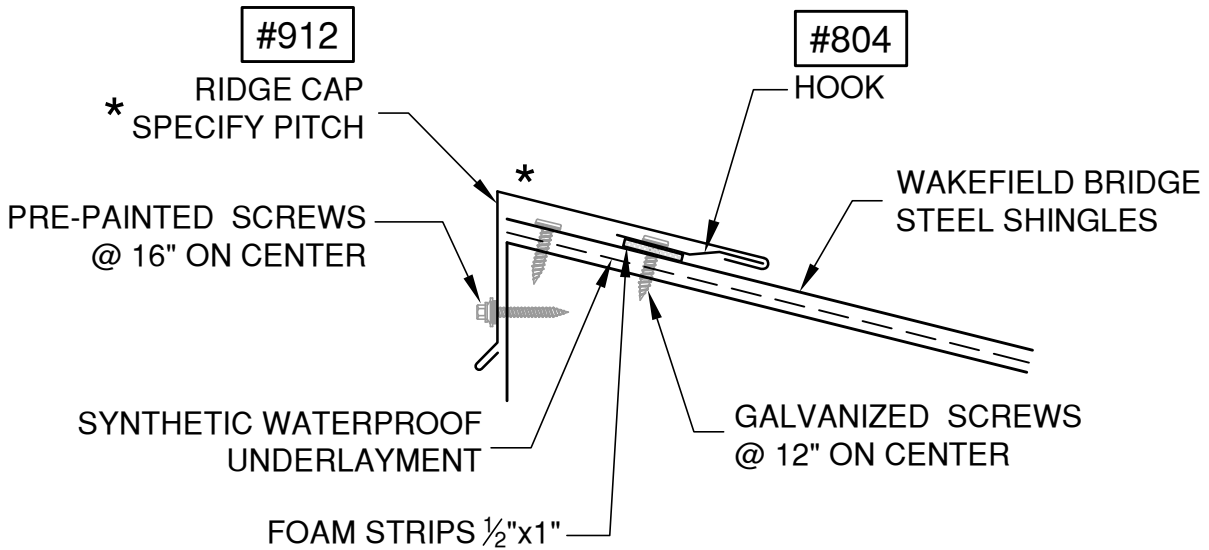

8.5 HALF RIDGE CAP DETAIL

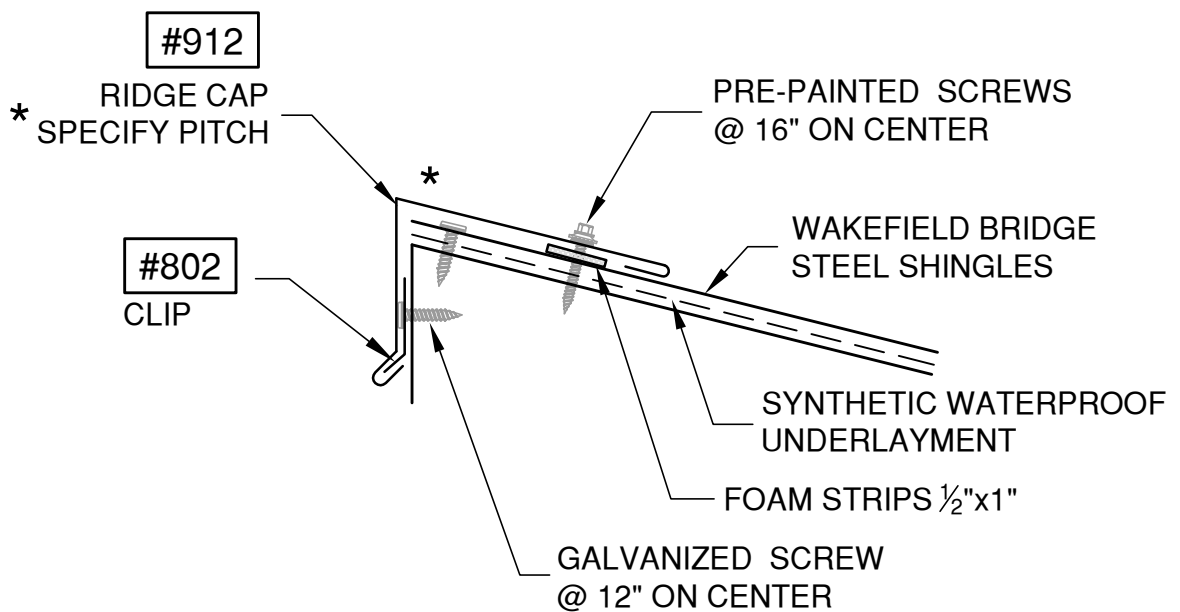

9.1 PLUMBING VENT DETAIL

-ONCE THE STEEL SHINGLES ARE INSTALLED, CUT THE "DEKTITE" TO THE APPROPRIATE DIAMETER, AND SLIDE OVER PIPE. SECURE THE DEKTITE'S BASE WITH A SEALANT (BETWEEN THE BASE AND ROOFING) THEN FASTEN.

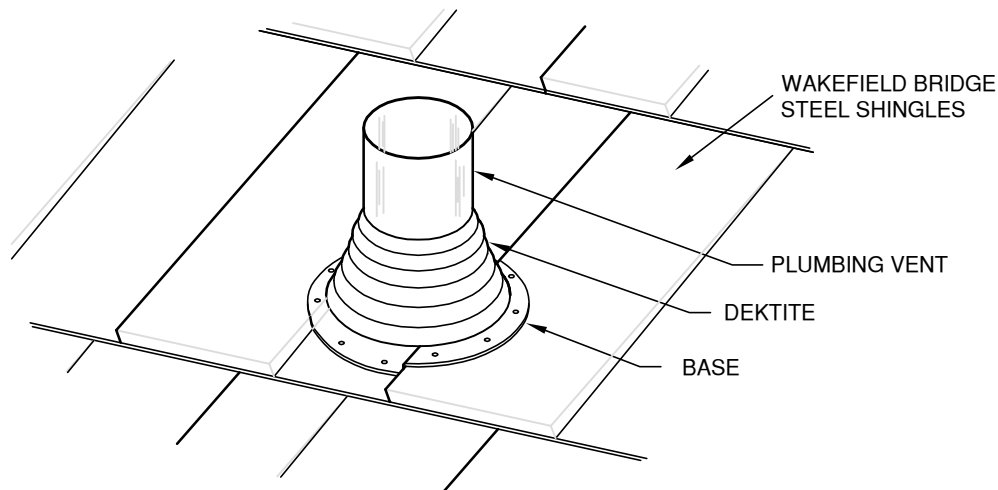

9.2 HYDRO MAST DETAIL

-ONCE THE STEEL SHINGLES ARE INSTALLED, CUT THE "RETROFIT DEKTITE" TO THE APPROPRIATE DIAMETER AND INSTALL AROUND THE HYDRO MAST. CLAMP THE FLASHING TOGETHER AND SECURE THE BASE WITH A SEALANT (BETWEEN THE BASE AND ROOFING) THEN FASTEN.

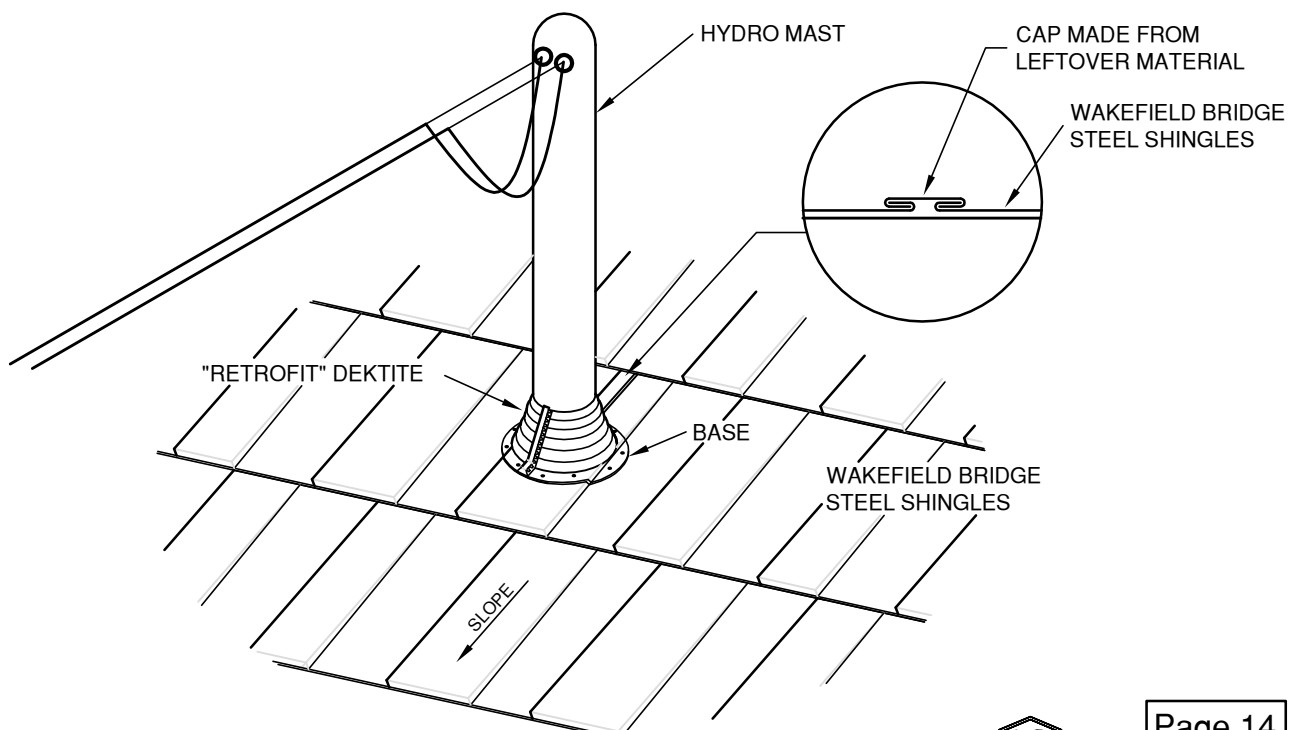

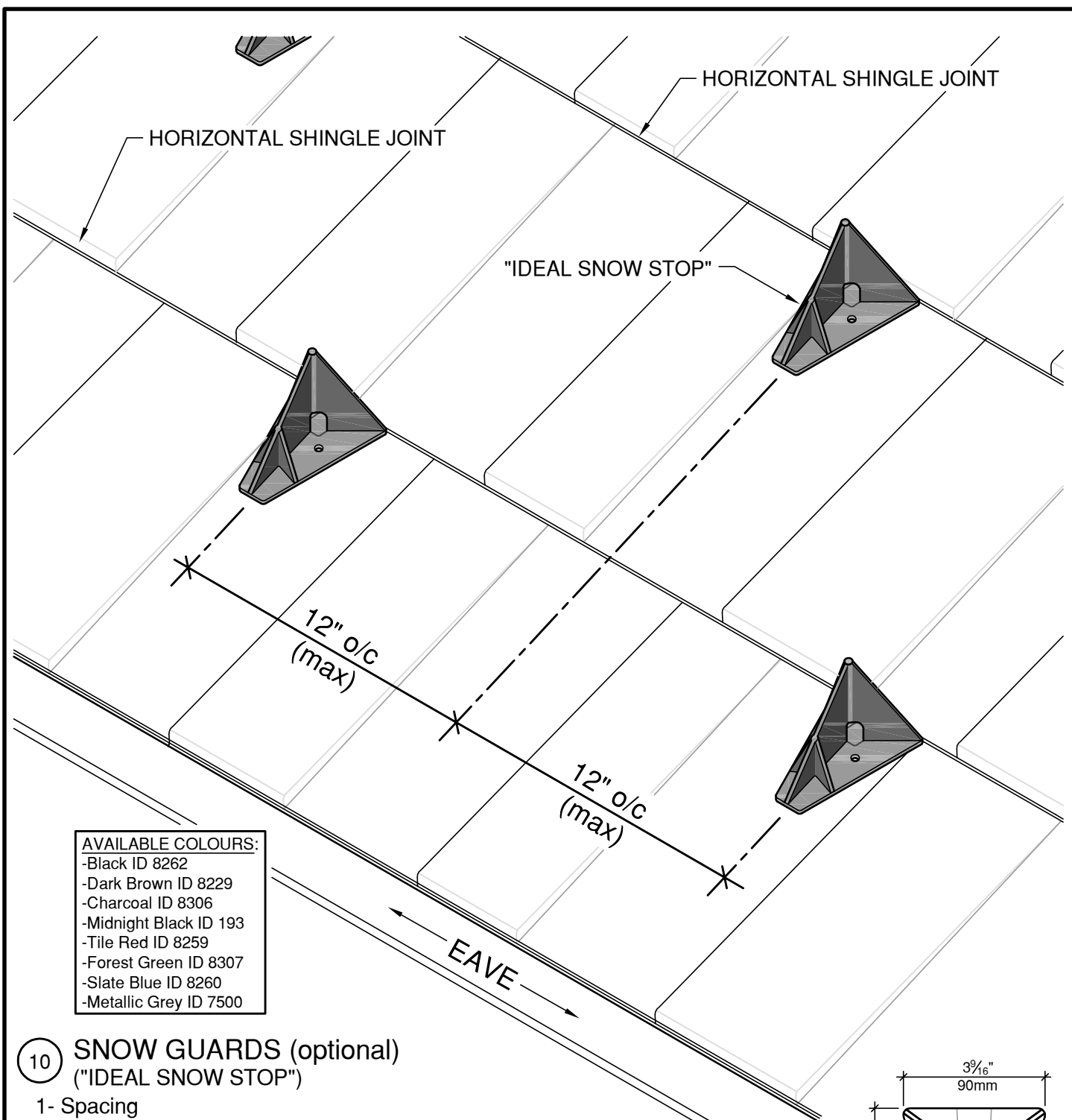

| AVAILABLE COLOURS: | |
|------------------------|--|
| -Black ID 8262 | |
| -Dark Brown ID 8229 | |
| -Charcoal ID 8306 | |
| -Midnight Black ID 193 | |
| -Tile Red ID 8259 | |
| -Forest Green ID 8307 | |
| -Slate Blue ID 8260 | |
| -Metallic Grey ID 7500 | |

10 SNOW GUARDS (optional) ("IDEAL SNOW STOP")

1- Spacing

- "Ideal Snow Stop" can be installed along the eaves, in areas where falling ice & snow is a concern.
- Install the "Ideal Snow Stop" up against a horizontal shingle joint, in 2 rows (staggered). Horizontal spacing should be 12" o/c (maximum).
- Note that the spacing between the "Ideal Snow Stop" may be reduced for steep roofs and/or roofs with long rafters.

2- Installation

- Spread bead of sealant evenly underneath the Ideal Snow Stop's base.
- Place the "Ideal Snow Stop" in position on metal surface by applying light and even pressure. Insure solid backing underneath the "Ideal Snow Stop".
- Use screws with neoprene washers through holes in the "Ideal Snow Stop" and tighten to cause approximately 50% compression in neoprene washers.
- Three screws to be used per "Ideal Snow Stop".

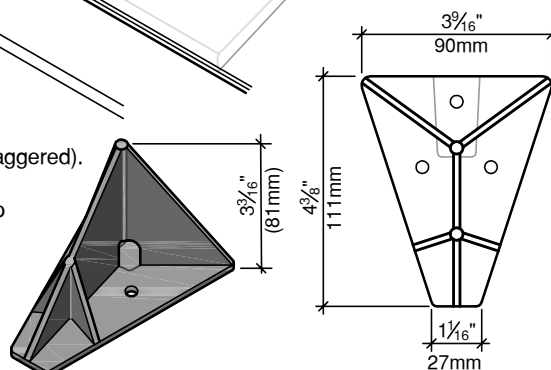

FLASHINGS AND TRIMS FOR THE WAKEFIELD BRIDGE STEEL SHINGLES

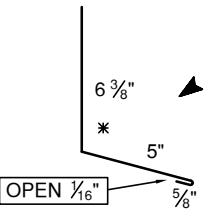
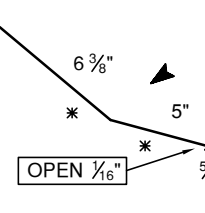
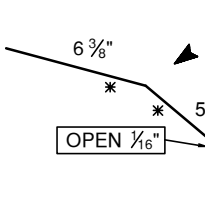
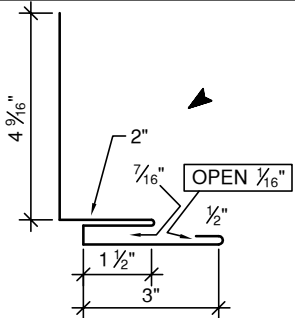
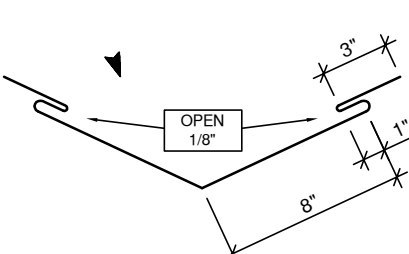
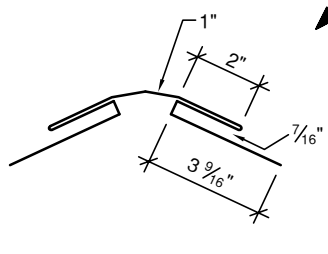
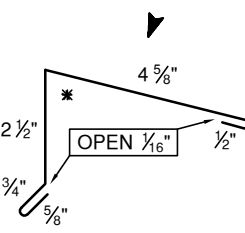
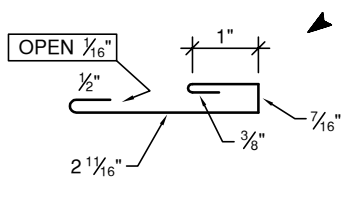
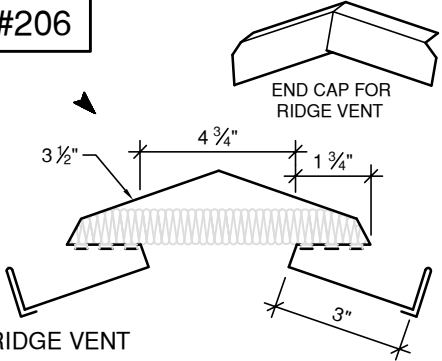
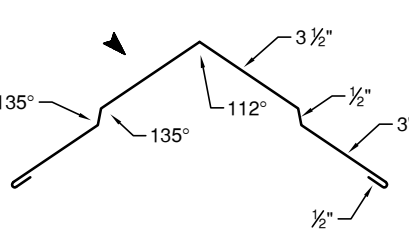
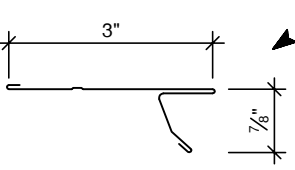
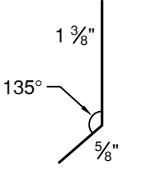
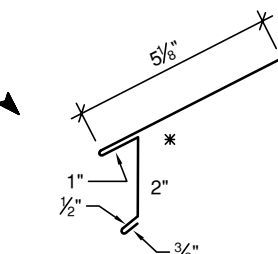
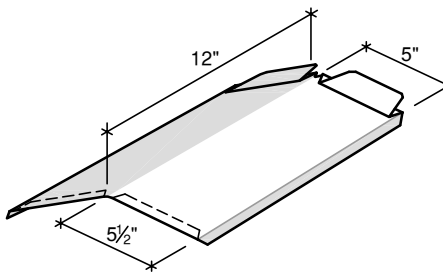
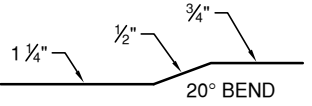
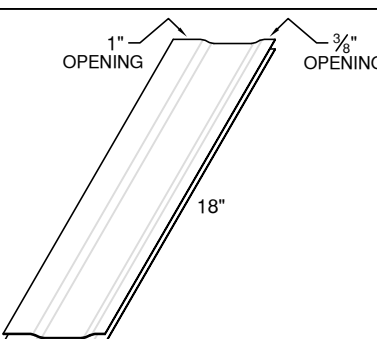
| | | |
|----------------------------------------------------------------------------------------------------------------------------------------------------------------------------------|--------------------------------------------------------------------------------------------------------------------------------------------------------------------------|---------------------------------------------------------------------------------------------------------------------------------------------------------------------------|
| <p>#905 TYPE 1</p>  <p>WALL FLASHING (12" GIRTH) * SPECIFY PITCH</p> | <p>#905 TYPE 2</p>  <p>TRANSITION FLASHING (12" GIRTH) * SPECIFY PITCHES</p> | <p>#905 TYPE 3</p>  <p>HIP FLASHING (12" GIRTH) * SPECIFY PITCHES</p> |
| <p>#906</p>  <p>WALL FLASHING (90°) (12" GIRTH)</p> | <p>#908</p>  <p>VALLEY (24" GIRTH)</p> | <p>#910</p>  <p>COTTAGE ROOF CAP (18" GIRTH)</p> |
| <p>#912</p>  <p>HALF RIDGE CAP (9" GIRTH) *SPECIFY PITCH</p> | <p>#916</p>  <p>SPECIAL "J" TRIM (5" GIRTH)</p> | <p>#206</p>  <p>RIDGE VENT</p> |
| <p>#214</p>  <p>"LIBERTY" RIDGE CAP (15" GIRTH)</p> | <p>#408</p>  <p>STARTER FOR SHINGLES</p> | <p>#802</p>  <p>CLIP (4" GIRTH, 26G, GALVANIZED) (TRIM TO 2")</p> |
| <p>#815</p>  <p>EAVE STARTER (9" GIRTH) * SPECIFY PITCH (MAX. PITCH 12/12)</p> | <p>WAKEFIELD BRIDGE CAPS (30 PCS PER BUNDLE)</p>  | <p>#804</p>  <p>HOOK (4" GIRTH, 24G, GALVANIZED) (TRIM TO 2 1/2")</p> |
| | | <p>FOLDING TOOL</p>  |

Appendix "A" Roof Bracket

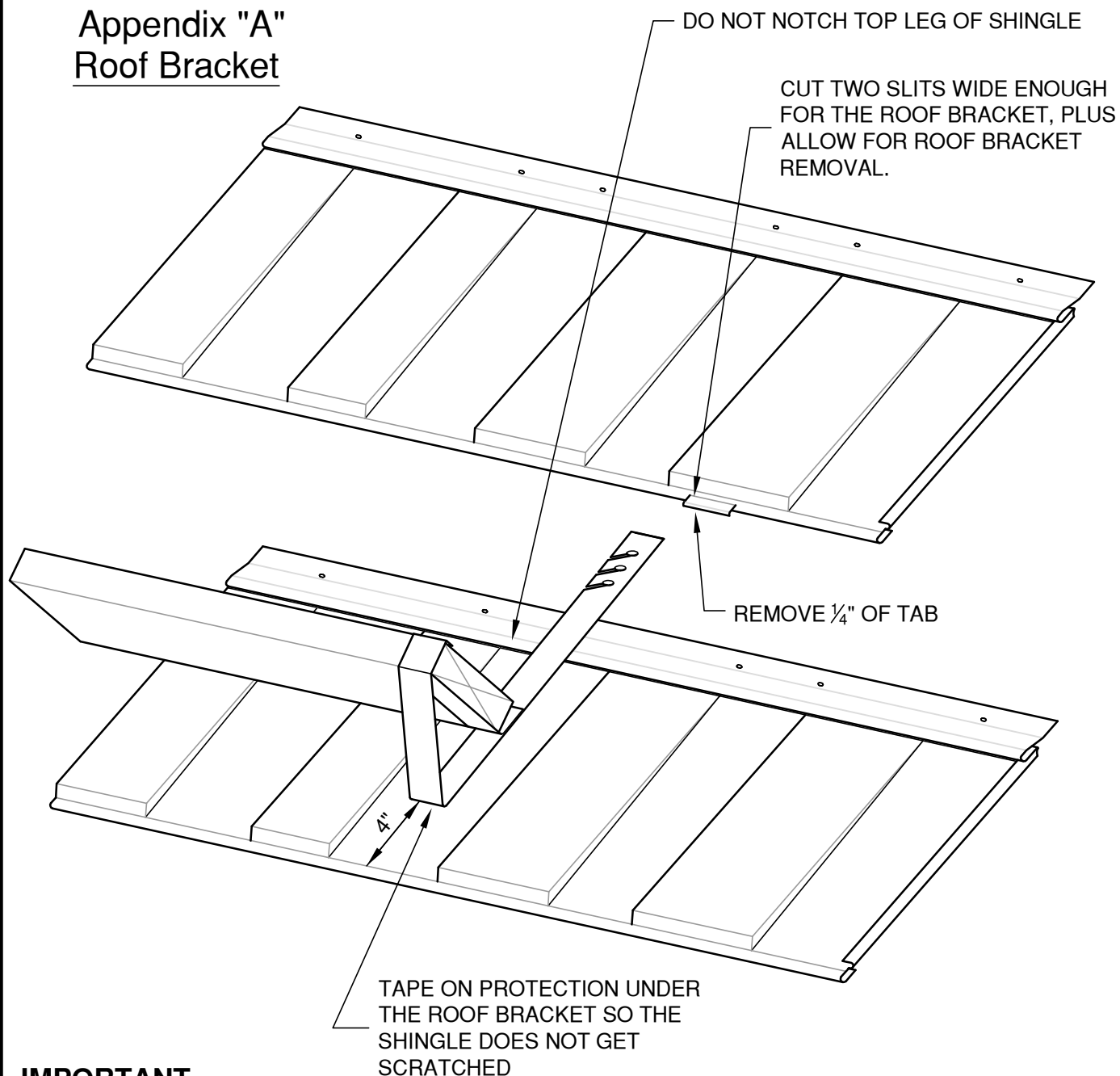

IMPORTANT

SEE ROOF BRACKET INSTRUCTIONS FROM THE MANUFACTURER FOR PROPER USE AND MOUNTING INSTRUCTIONS REQUIRED.

THE FOLLOWING INSTRUCTIONS DESCRIBE THE INSTALLATION SEQUENCE.

- 1- INSTALL BOTTOM SHINGLE.
- 2- MOUNT ROOF BRACKET OVER TOP OF SHINGLE (SEE DIAGRAM).
- 3- REMOVE ROOF BRACKET WHEN DONE INSTALLING TOP SHINGLES.
- 4- AFTER REMOVING THE ROOF BRACKET, RAISE THE BOTTOM EDGE OF THE TOP SHINGLE WITH A CLAW HAMMER ON EACH SIDE OF TAB WHEN FOLDING TAB BACK IN BY HAND. DO FINAL TUCK WITH A NARROW NON-MARRING TOOL.

NOTE: ROOF BRACKETS ARE AVAILABLE IN BUILDING MATERIAL RETAILERS.





Estimate Sheet

(Wakefield Bridge Steel Shingles)

COMPANY: _____

CITY: _____

CONTACT: _____

PHONE: _____

FAX: _____

EMAIL: _____

JOB NAME: _____

JOB
ADDRESS: _____

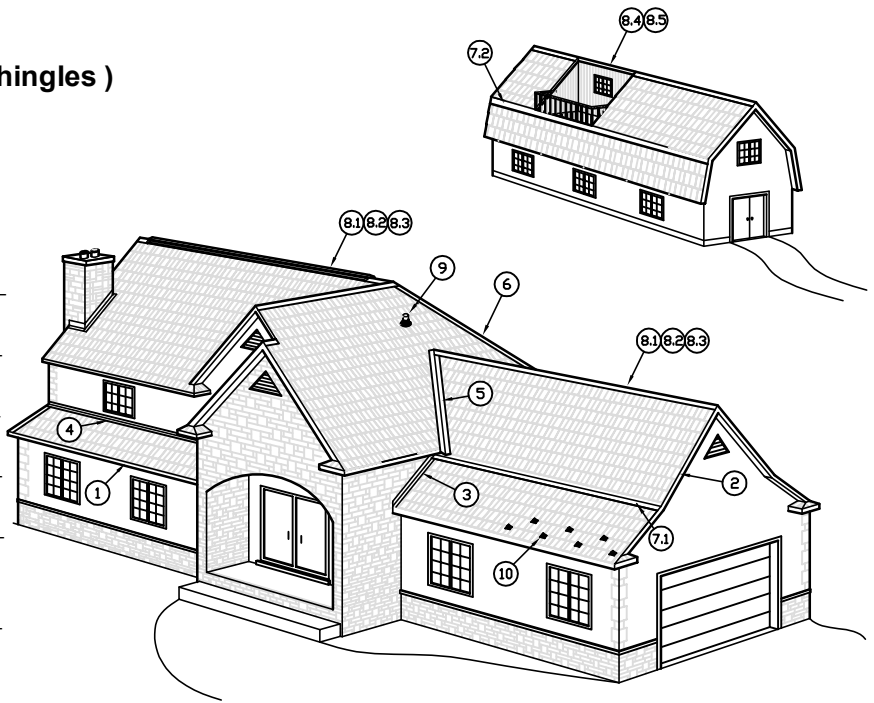

Colour: _____

Steel Shingles

Total Roof Area _____ ÷ 50 = _____ Boxes

Total Boxes x \$ _____ per box = \$ _____

① Eave / Starter

- Starter # 408 or # 815 (10 ft)

Total Length _____ x \$ _____ per lin./ft = \$ _____

② Gable / Rake

- Starter # 408 or # 815 (10 ft)

Total Length _____ x \$ _____ per lin./ft = \$ _____

- "J" trim # 916 (10 ft)

Total Length _____ x \$ _____ per lin./ft = \$ _____

③ Wall Detail 90°

- # 906 (10 ft)

Total Length _____ x \$ _____ per lin./ft = \$ _____

④ Wall Detail (slope)

- # 905 TYPE 1 (10 ft)

Total Length _____ x \$ _____ per lin./ft = \$ _____

- Hook # 804 (10 ft)

Total Length _____ x \$ _____ per lin./ft = \$ _____

⑤ Valley Detail

- Valley # 908 (10 ft)

Total Length _____ x \$ _____ per lin./ft = \$ _____

⑥ Hip Detail

- Cottage Roof Cap
910 (10 ft)

Total Length _____ x \$ _____ per lin./ft = \$ _____

- Wakefield Bridge Cap
(30 pcs per bundle)

Total Pieces _____ x \$ _____ per piece = \$ _____



(7.1) Détail solin de transition

- Solin # 905 TYPE 2 (10 pi) Longueur Total _____ x \$ _____ par pi lin = \$ _____

- Crochet # 804 (10 pi) Longueur Total _____ x \$ _____ par pi lin = \$ _____

(7.2) Détail solin de transition (Arêtier)

- Solin # 905 TYPE 3 (10 pi) Longueur Total _____ x \$ _____ par pi lin = \$ _____

- Crochet # 804 (10 pi) Longueur Total _____ x \$ _____ par pi lin = \$ _____

Détail du faîte

(8.1) - Faîtière "Liberté" # 214 (10 pi) Longueur Total _____ x \$ _____ par pi lin = \$ _____

(8.2) - Faîtière Ventilée (10 pi) Longueur Total _____ x \$ _____ par pi lin = \$ _____

- Bout pour Faîtière Ventilée (Mcx) Pièces Total _____ x \$ _____ par pièce = \$ _____

(8.3) - Faîtière Wakefield Bridge
(30 mcx par paquet) Pièce Total _____ x \$ _____ par pièce = \$ _____

(8.4)(8.5) - Demi-Faîtière # 912 (10 pi) Longueur Total _____ x \$ _____ par pi lin = \$ _____

(8.4) - Crochet # 804 (10 pi) Longueur Total _____ x \$ _____ par pi lin = \$ _____

(8.5) - Réglette # 802 (10 pi) Longueur Total _____ x \$ _____ par pi lin = \$ _____

Accessoires

- Outil de pliage Pièces Total _____ x \$ _____ par pièce = \$ _____

- Éthafoam (Rouleau 25 pi) Rouleaux Total _____ x \$ _____ par rouleau = \$ _____

- Fermeture EPDM (1/2"x1"x25') Longueur Total _____ x \$ _____ par pi lin = \$ _____

- Calfeutrage de Butyl (300 ml) Tubes Total _____ x \$ _____ par tube = \$ _____

- **Vis galvanisée 1" (tête plate)** Total par/100 _____ x \$ _____ par/100 = \$ _____
(min. 90 mcx / boîte bardeaux)

- **Vis galvanisée 1.5" (tête plate)** Total par/100 _____ x \$ _____ par/100 = \$ _____
(min. 90 mcx / boîte bardeaux)

- **Vis pré-peinte 1.5"** Total par/100 _____ x \$ _____ par/100 = \$ _____

- Feuille unie (4' x 10') Feuilles Total _____ x \$ _____ par feuille = \$ _____

(9) - Dektite "tuyaux" (#3, #4 & #8) Pièces Total _____ x \$ _____ par pièce = \$ _____

- Dektite "Cheminée" (#8 HT) Pièces Total _____ x \$ _____ par pièce = \$ _____

- Dektite Retrofit
"mât d'hydro" (#802) Pièces Total _____ x \$ _____ par pièce = \$ _____

- Peinture à retouche (0.5 oz) Canette Total _____ x \$ _____ par canette = \$ _____

(10) - Arrêt de Neige Idéal (Garde-neige) Pièces Total _____ x \$ _____ par pièce = \$ _____

Coût total des matériaux \$ _____

Note: Consultez notre guide d'installation
pour plus de détails sur les solins
& les accessoires.

